

- Montageanleitung
- Assembly instructions
- Notice de montage
- Montagehandleiding
- Návod na montáž
- Instrucțiune de montaj
- Navodila za namestitev
- Installationstruktioneer

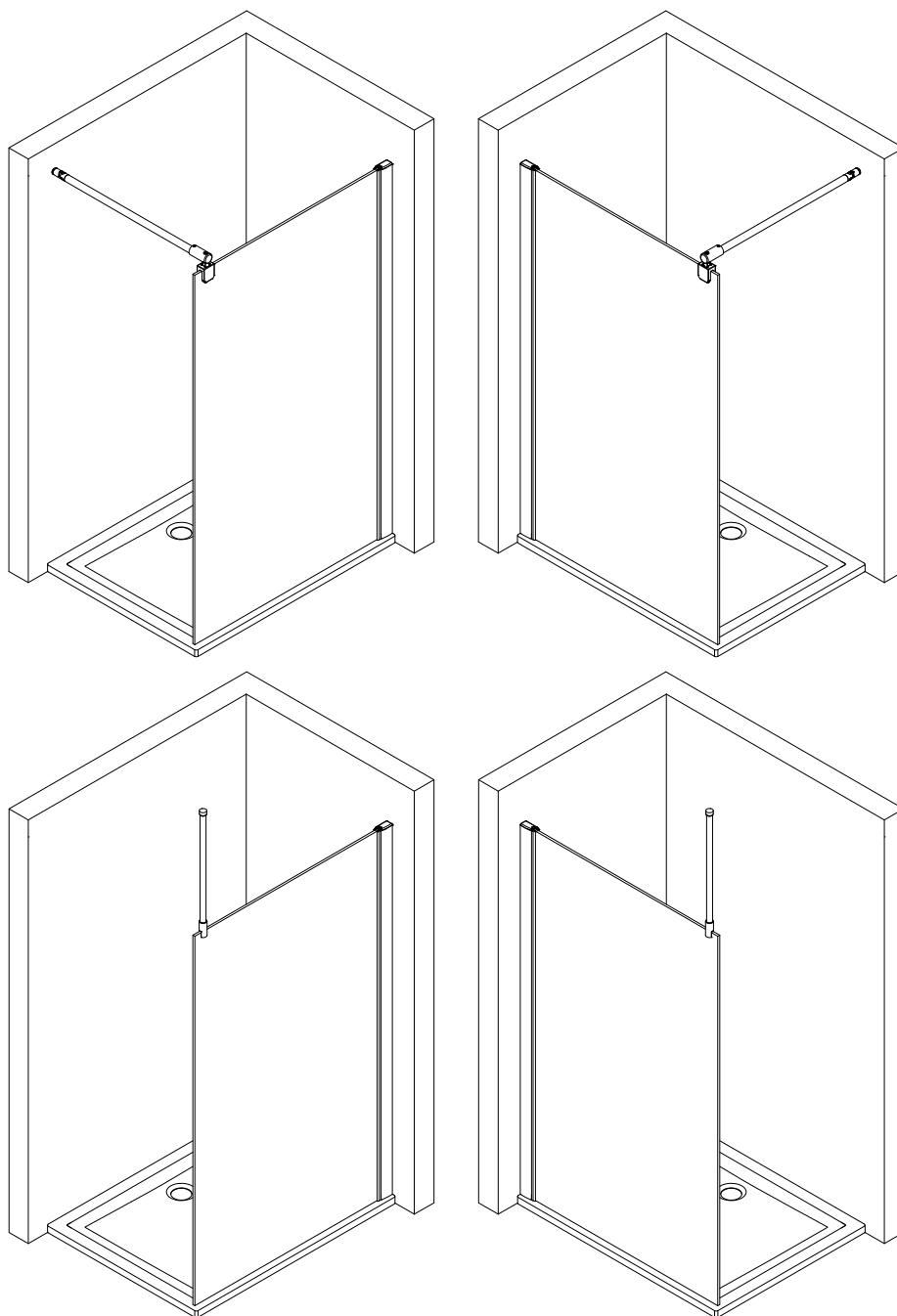

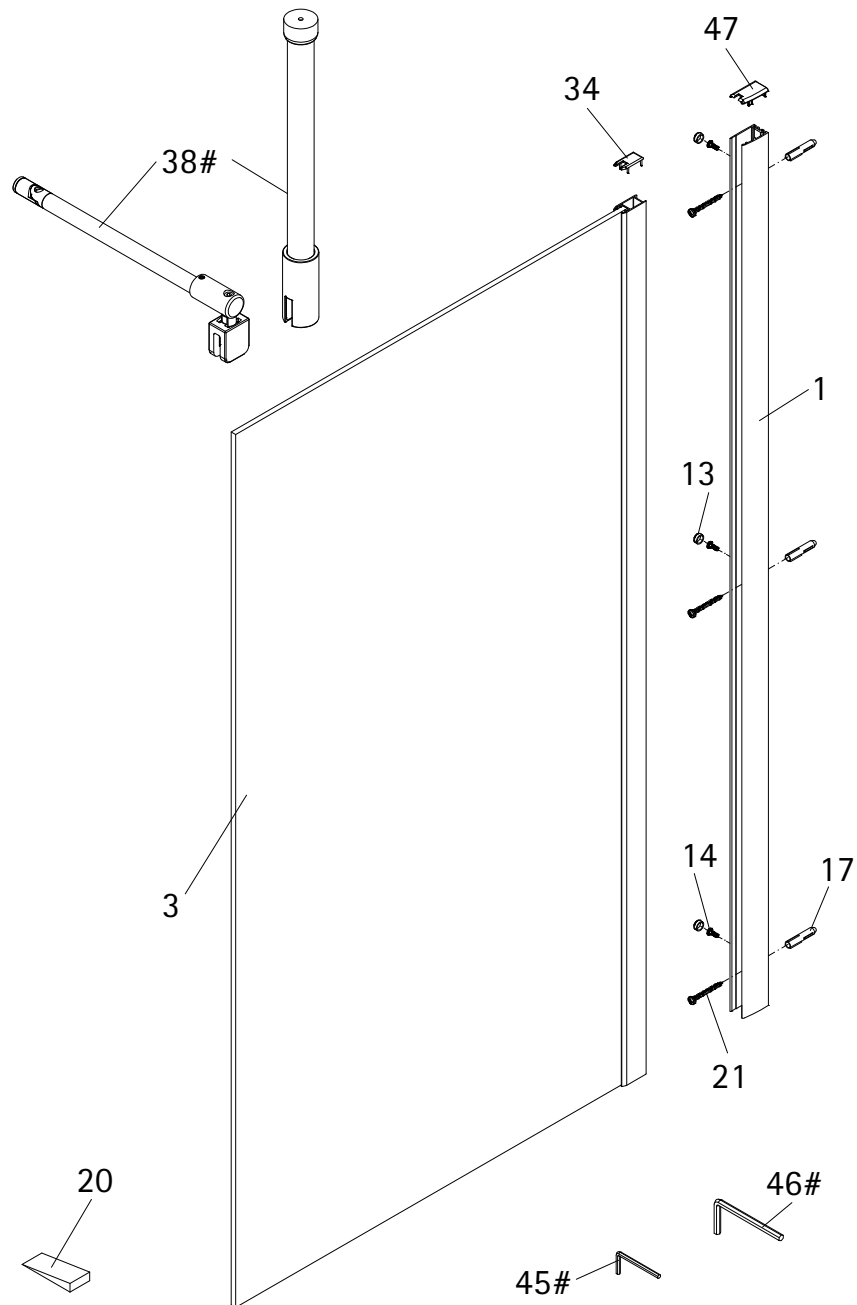

Pos.	Bezeichnung	Ersatzteil-Nr.	Preis
1	1x Wandanschlussprofil	E 23230	34,95 €
3	1x Seitenwand		
13*	3x Abdeckkappe für Kappenschraube		
14*	3x Kappenschraube 3,5 x 9,5 mm		
17*	3x Dübel S6		
20	1x Silikonkeil (6 Stk.)	E 23203	13,95 €
21*	3x Linsen-Blechkopfschraube 4,2 x 45 mm		
34	1x Abdeckkappe		

Pos.	Bezeichnung	Ersatzteil-Nr.	Preis
38#	1x Seitenwandabstützung komplett	E 23320	29,95 €
38#	1x Deckenstrebe komplett	D 2966	79,95 €
45#	1x Innensechskantschlüssel 2		
46#	1x Innensechskantschlüssel 4		
47	1x Abdeckkappe		
* Schrauben- und Abdeckkappenset		E 23200	22,95 €
# optional			

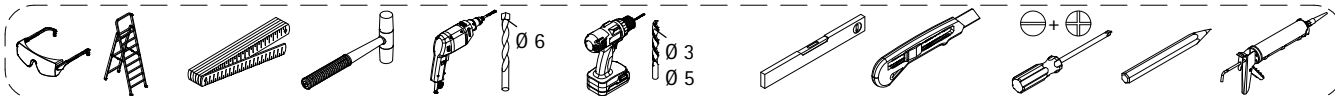
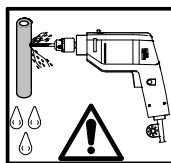
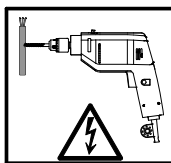
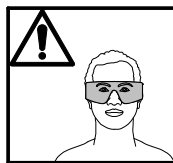
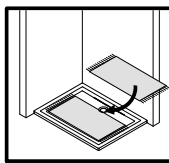
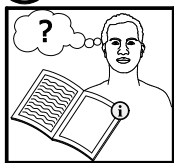

1

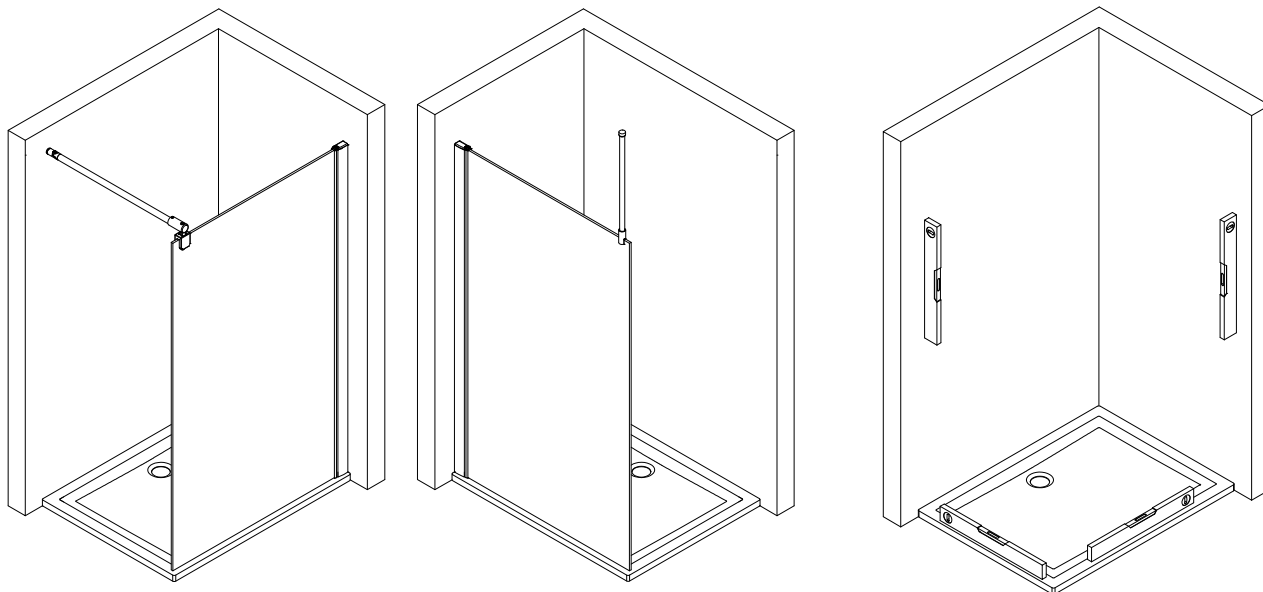

2

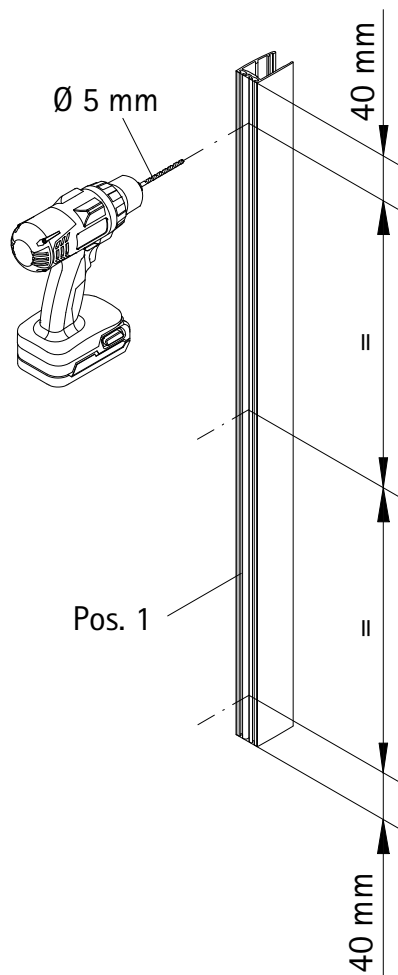

3

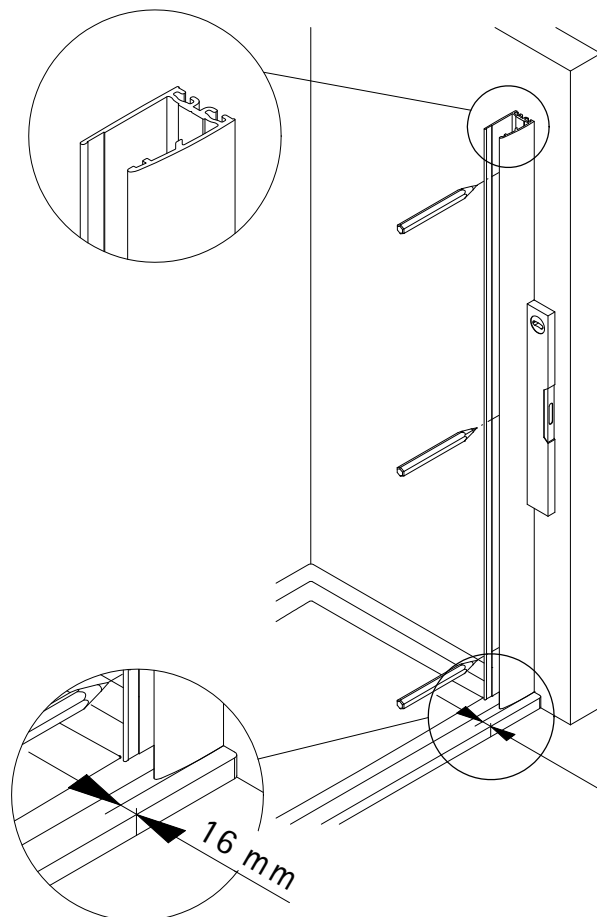

4

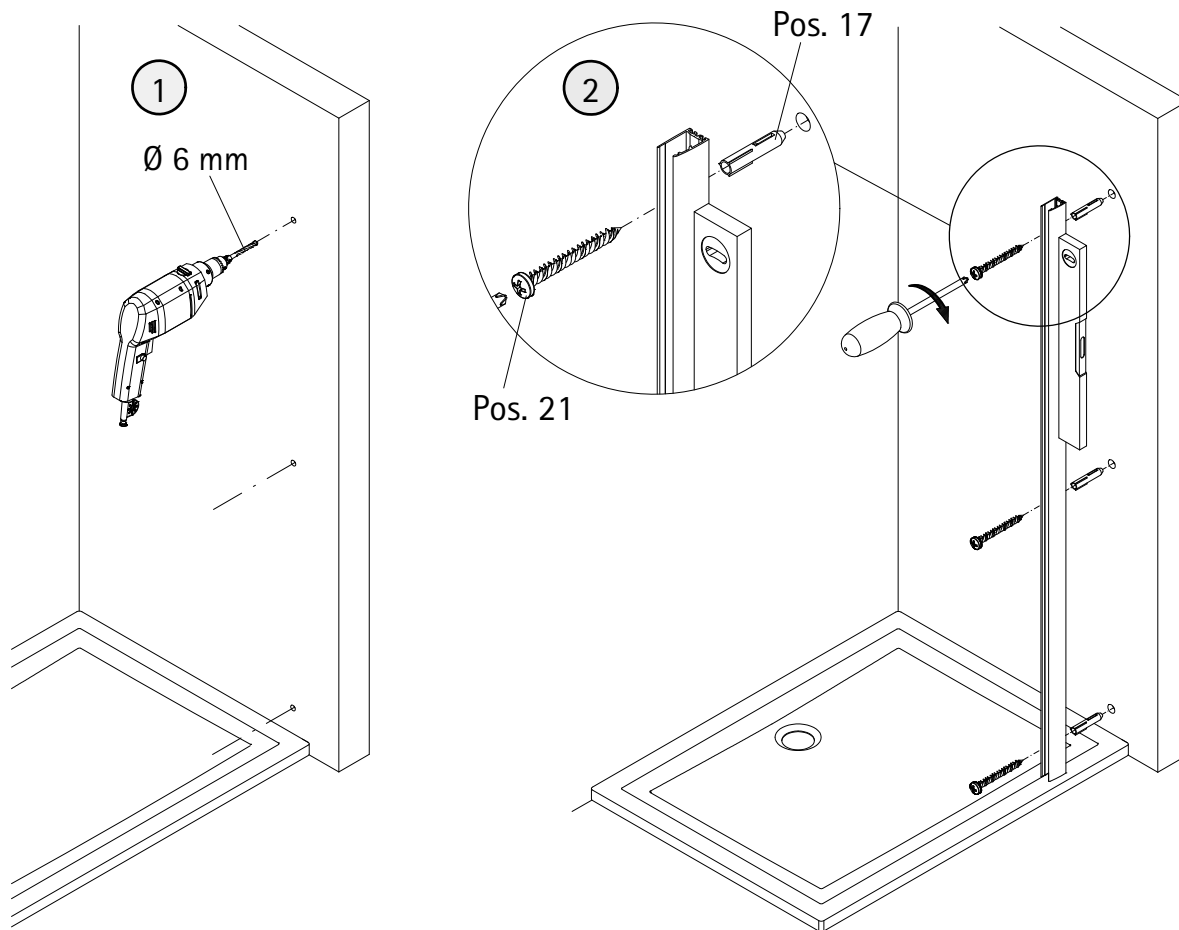

5

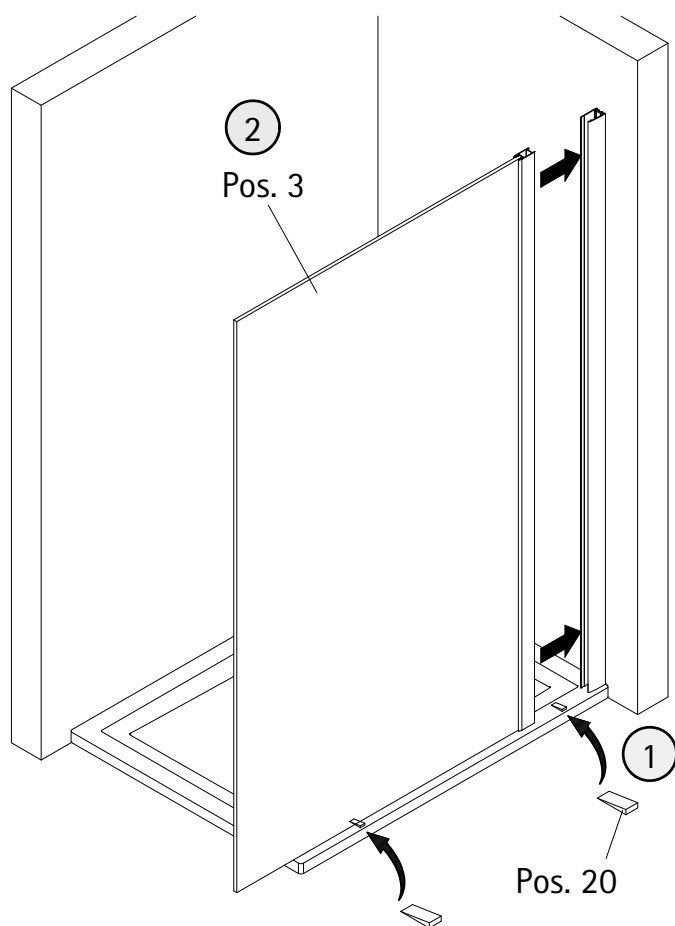

6

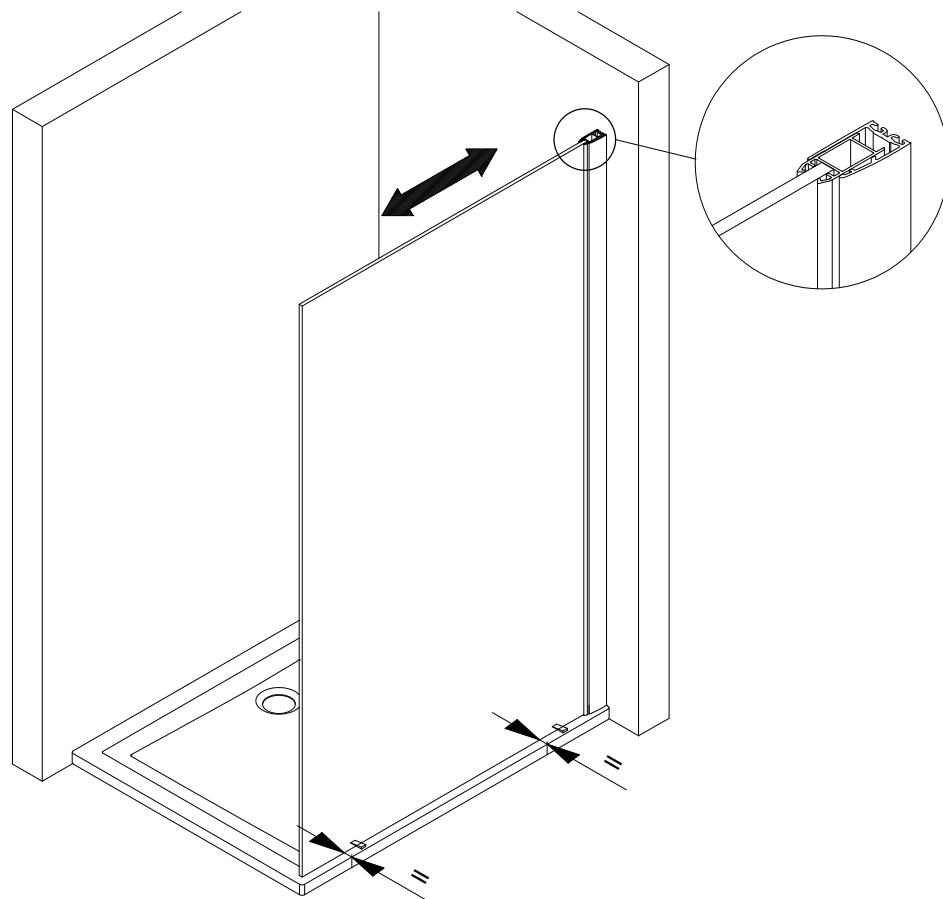

7

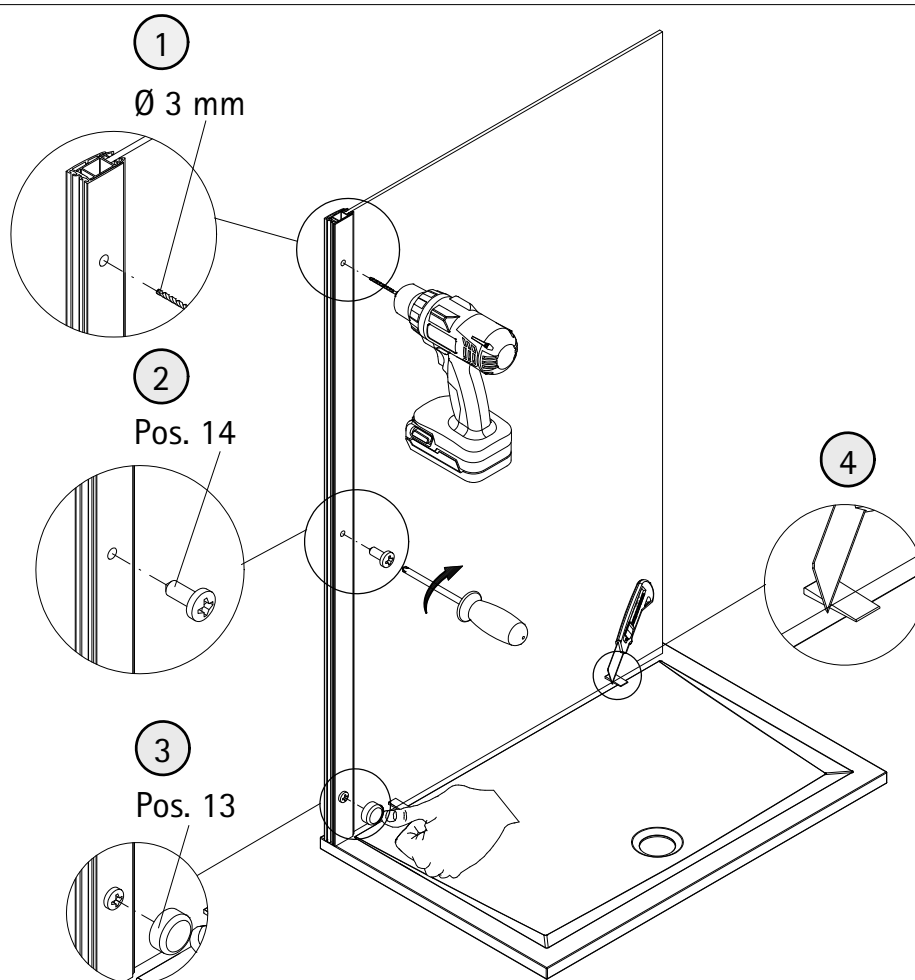

8a

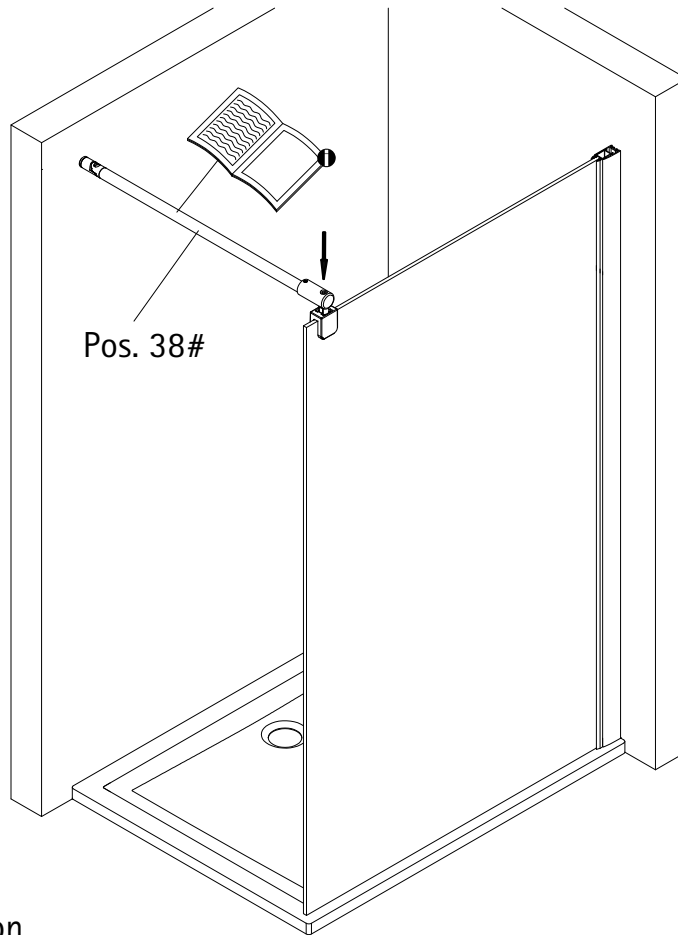

optional, en option

8b

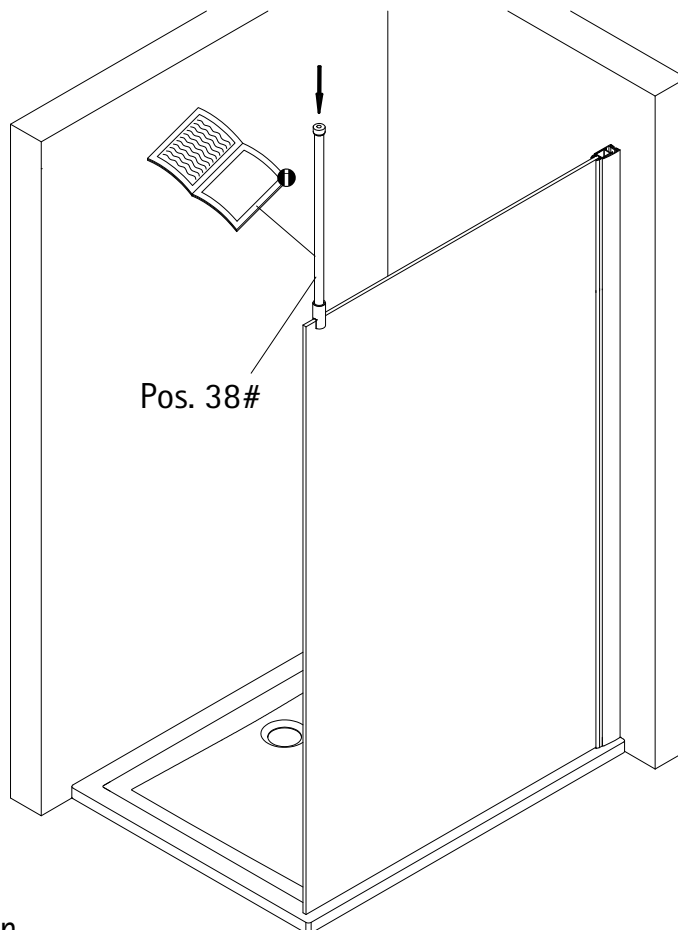

optional, en option

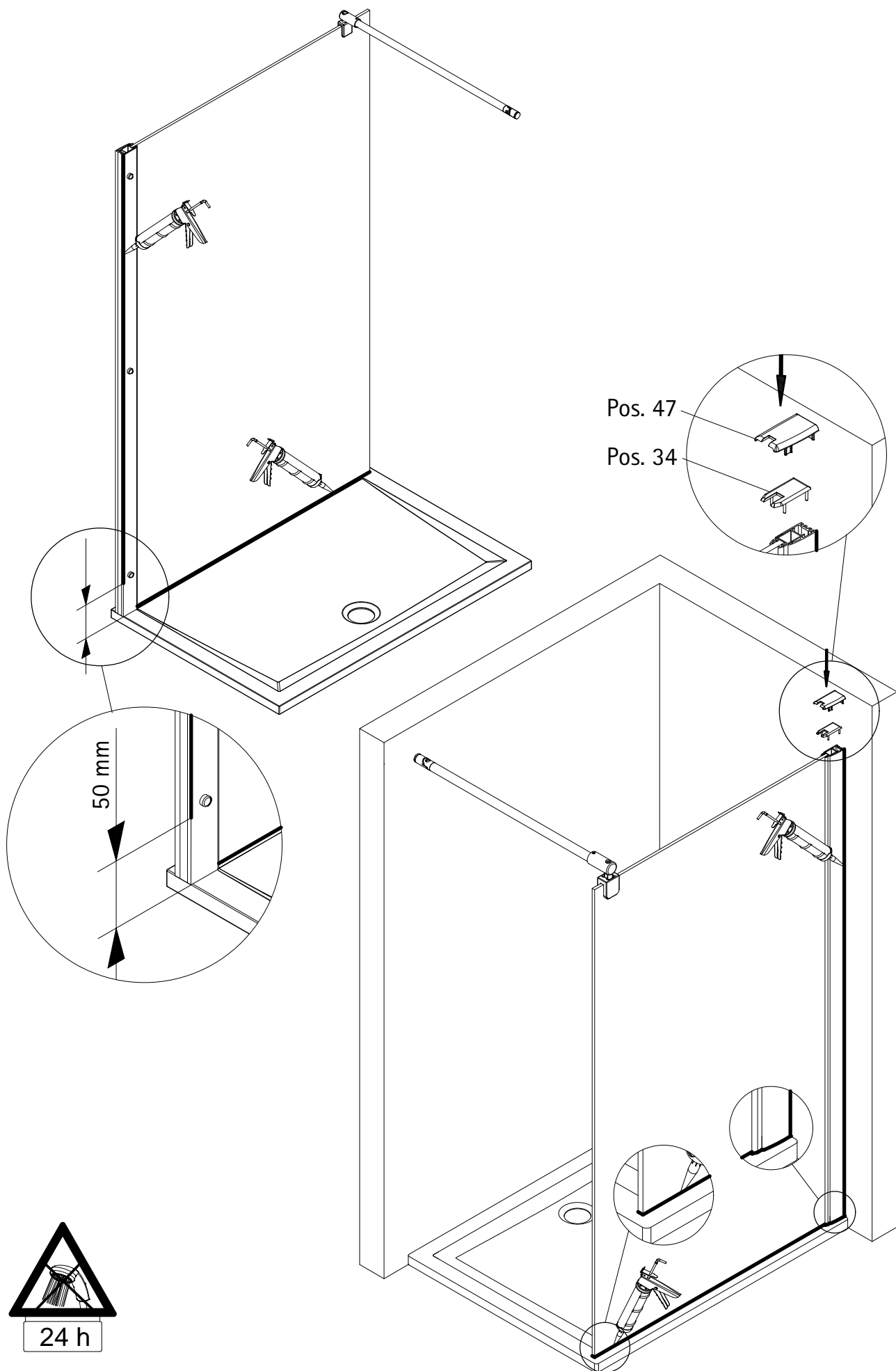

854-3

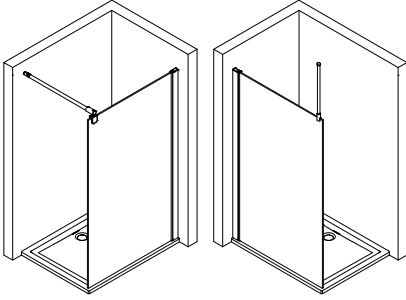

Kontrollbeleg
Control Receipt

Prüfnummer/ Inspection number



Duschservice
Zum Hohlen Morgen 22
59939 Olsberg
Deutschland / Germany / Allemagne / Duitsland



Ersatzteilbestellung:
Fax 02962 / 972-4260



Allgemeine technische Probleme:
Telefon 02962 / 972-40



E-Mail:
ersatzteile@duschservice.de